

Check in procedure – Camp Gallahue

Upon your arrival at Gallahue, please proceed to the facility/unit that you have reserved. The Site Manager or Ranger will come to your unit later to check in with you.

[T/nas drive/campingservices/troopcamp/Gallahue/ checkinproecedure](#)

Girl Scouts of Central Indiana
CAMP GALLAHUE
6758 Bear Creek Road
Morgantown, IN 46160

Camp Gallahue consists of approximately 800 acres in Brown County near Morgantown, IN. The camp is located approximately 50 miles south of the GSCI Indianapolis Metro Office.

The council employs an onsite manager at Gallahue. The site manager and ranger are there to maintain the facilities and to aid groups while using them. A staff ranger, not always the on-site person, is on call at camp 24 hours/seven days a week except published holidays.

Council Emergency: 317.924.6800 or toll free 877.474.2248

Camp Phone Number: 812.597.4692

Site Manager: 812.703.0909

Ranger Cell: 812.369.6913

Arrival and Departure

Check in and check out times are as follows: Any change in these times needs to be requested at the time of reservation. **Check in: 4:00 pm or after** **Check out: 2:00 pm or before**

If troops want to check-in before the specified time, they need to pay for the day/night before as well. If troops want to check out later than the specified time, they need to pay for the next day/night as well.

Smoking: Smoking is PROHIBITED on all Girl Scout properties.

Pets: Pets are not permitted in the camp with the exception of service dogs. Please make us aware if someone has a service dog.

Alcohol and Drugs: Alcoholic beverages and drugs are strictly prohibited.

Cancellations

The full fee for use of the facility is due in the office one month before the reservation. If payment is not received in the office one month before the reserved date, the reservation will be cancelled.

The funds will be transferred to another date if

- A cancellation is received three weeks prior to the event.
- Weather conditions causing travel to be hazardous or camp to close.

When it is necessary to cancel please call the council office as soon as possible so that another group might be considered. Someone is always expecting your group; please notify the office even at the last minute if you plan not to attend. You may call 317.924.6827 or 317.924.6856 at any hour and leave a message.

DESCRIPTION OF FACILITIES

FOUR TENT UNITS (ARDATH, ART COLONY, VILLAGE & RESERVATION) each unit consists of a large activity cabin with ten nearby platform tents (*each platform tent contains 4 cots with mattresses*) for sleeping. Sanitary facilities are pit latrines, enclosed and partitioned. Cabins have modern kitchens and substantial activity space, to be shared by troops staying in the unit, for get-togethers, cooking, etc. Equipment included in each unit area cabin: fireplace, five tables and chairs seating 8 each, gas furnace (Ardath & Art Colony only, have a gas furnace). Included in the kitchen are triple sinks with hot and cold running water, electric refrigerator and freezer compartment, gas range and oven, four burners and griddle, storage cabinets, work table.

HILLCREST has 3 wings each consisting of sleeping room with cots & mattresses, private restroom and showers, table and chairs, and modern kitchen and gas furnace. *(Wing 1 has 14 beds, Wing 2 has 12 beds, Wing 3 has 14 beds) Kitchen: Electric range/oven, microwave, double sink w/ hot & cold running water, refrigerator/freezer, cabinets, small counter area. (*There are 5 fire bowls near Hillcrest for troops/groups to use*).

LODGE: The Gallahue Lodge contains:

- Large institutional kitchen (includes griddle)
- Seats 150 for meals
- Sleeping accommodations for 50 (mattresses provided) (LODGE BASEMENT ONLY)
- Patio overlooking the lake
- Heated for year round use
- Three fireplaces with the large one in the upstairs main room, one in basement, & one outside the basement. *(There are no fire bowls located near the Lodge)*
- Easy access for the handicapped
- Lodge basement includes modern kitchen includes: refrigerator/freezer, electric range/oven, Microwave, double bowl sink)
- Microwave (1 big one in upstairs of Lodge, 1 small/regular size in basement kitchen)
- Shower (one shower located in basement of Lodge)

ADIRONDACK UNIT (Harley's Hill) Three sided shelter for sleeping picnic style shelter (located behind Village) with tables, a pit latrine, fire bowl. NO ELECTRICITY OR WATER. Sleeps a total of 20 persons/ 4 huts each sleeping 5 persons.)

PRIMITIVE CAMPING SITES: Unlimited site capacity. Sites include fire bowls, fire grates, and picnic tables. Water is available from a pump located in the center of the valley. Sanitary facilities are pit latrines, enclosed and partitioned. They are located at each end of the valley.

SHOWERS: A central camp shower (all showers are individual) with hot and cold running water is available for your use April 1 through November 1. The shower house is located near the Lodge. Porta potties are also located near the Beach Area.

PICNIC AREA – Available for day use. Sanitary facilities are pit latrines, enclosed and partitioned. They are located at each end of the valley.

ACTIVITIES ON SITE

WATERFRONT: Open April 1 thru October 31 (excluding mid-late May thru early August). The waterfront is available for use on Saturdays from 10:00 a.m.-12:30 p.m. and/or 1:00-3:30 p.m. Troops must reserve the Waterfront through the council prior to date of use for one of these time periods. The council provides trained waterfront staff for swimming and certified small craft safety personnel supervision for boating activities. These activities can include canoeing, kayaking, row boating, and use of the pontoon boat. All swimming and boating takes place in designated areas only.

ARCHERY: *(Girls must be age 9 and above to use archery equipment).* Open April 1 thru October 31 (excluding mid-late May thru early August). *An archery range with equipment is available for troops and groups to reserve prior to date of use. Please note: Troops/Groups must supply their own Certified Archery Instructor in order to use the range & equipment.*

AMPHITHEATER: Troops and service units may reserve this outdoor arena for large group productions, campfires, meetings and recognition events. (The amphitheater has electricity and has seating for up to 200 persons). A sound system is available for use at the Amphitheater, however, request for use of the sound system, must be made prior to use so rangers can set up.

HIKING TRAILS: The Hills of Gallahue Trail is approximately 7½ hilly miles. A patch is available to all hikers who complete the trail and may be purchased at the Girl Scout Service Center Showcase Store.

TETHERBALL is offered in each unit area at Gallahue.

(continued)

Housekeeping

The rangers do not perform cleaning services. It is the responsibility of everyone using the camp property to leave it in better condition than they found it. The facilities ultimately belong to each Girl Scout and will reflect the care she gives them.

- ☐ Please condense and place all other trash/garbage in lined containers provided at each site. Please make sure each container is secure to discourage wildlife.
- ☐ Please replace all trash can liners.
- ☐ Please do not burn trash.

A Property Check-in/Check Out Usage Report form is included in this confirmation packet. It is a reminder of the things that will welcome the next group. Please fill out this form and leave it in the unit kitchen. Make sure that any repairs that are needed or damage that may have occurred has been noted.

Housekeeping Supplies

Each group must provide their own eating utensils. It is important that all paper products be removed from the latrines, tents, and units at the end of your stay. Brooms, mops, rakes, and shovels are available in each unit.

Troop Camp Equipment List

(Provided in Ardath, Art Colony, Village & Reservation unit house kitchens,
as well as Lodge basement kitchen & each wing of Hillcrest)

1 skillet	2 large stock pots	2 long handled forks
2 long handled spoons	1 rubber scraper	1 potato peeler
3 paring knives	1 ladle	1 pair tongs
1 rake	1 can opener	1 butcher knife
1 shovel	3 fire buckets	2 plastic mixing bowls
4 foot tubs (wash buckets)	1 broom	2 pancake turners
2 microwave containers (Hillcrest only)		

Wood/Fuel

Minimal Impact Camping/Leave No Trace suggests that you gather sticks from the ground no bigger than an adult wrist. Please do not snap branches off live, dead, or downed trees. Limiting the need or size of a wood fire will help to keep our woods healthy. To reduce the need to burn wood, consider the use of alternative fuels (i.e. charcoal or propane). Propane fuel stoves, cookers, and lanterns are available upon request for use at each site.

GENERAL INFORMATION

Serious Accidents or Emergency in Camp

Please report to the Site Manager or Camp Ranger immediately. Follow the emergency information provided. Camp Gallahue is covered by 911.

MAJOR EMERGENCY

In case of a major emergency: **NOTIFY SITE MANAGER 1ST, CELL PHONE # IS 812.703.0909**

1. Secure appropriate emergency personnel (police, fire, rescue, other)
2. Keep a responsible adult at the scene of the accident. Make no statements to reporters.
3. Notify parent/legal guardian.
4. Contact the Girl Scout Service Center 24 hour Major Emergency Phone number: 317.317.924.6800 or toll free: 877.474.2248.

OTHER ACCIDENTS

1. Take care of injured person.
2. Notify parents/legal guardian.
3. Contact Site Manager immediately, the cell phone # is 812.703.0909

See Volunteers Resource for Girl Scout Basic Accident Insurance Information.

Rev.11/5/13 T/nasdrive/campingservices/troopcamp/generalinfo&facilitiesatGallahue

Hillcrest wing 3

Hillcrest wing 2

Hillcrest wing 1

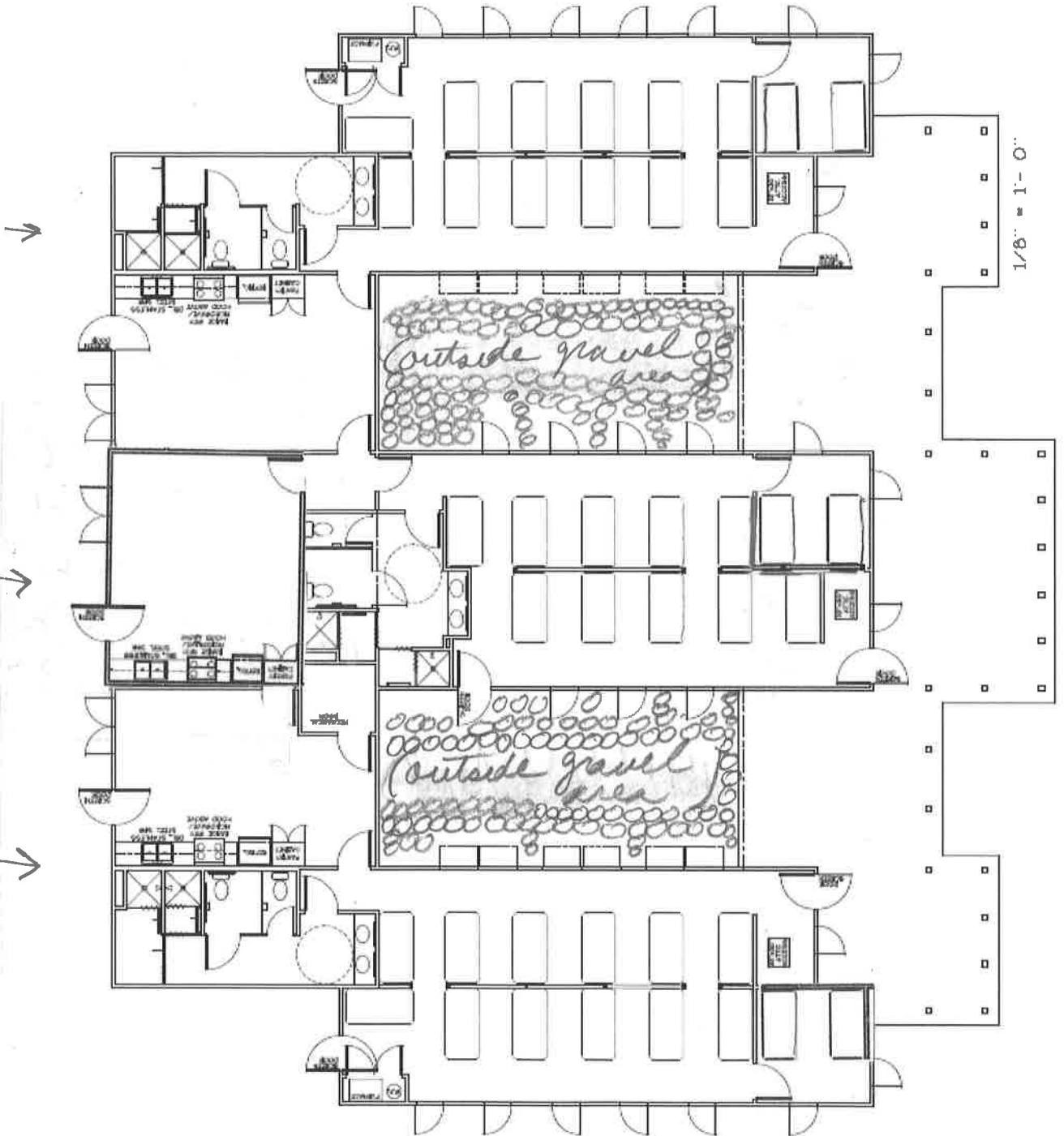

Hillcrest wing 3

Hillcrest wing 2

Hillcrest wing 1

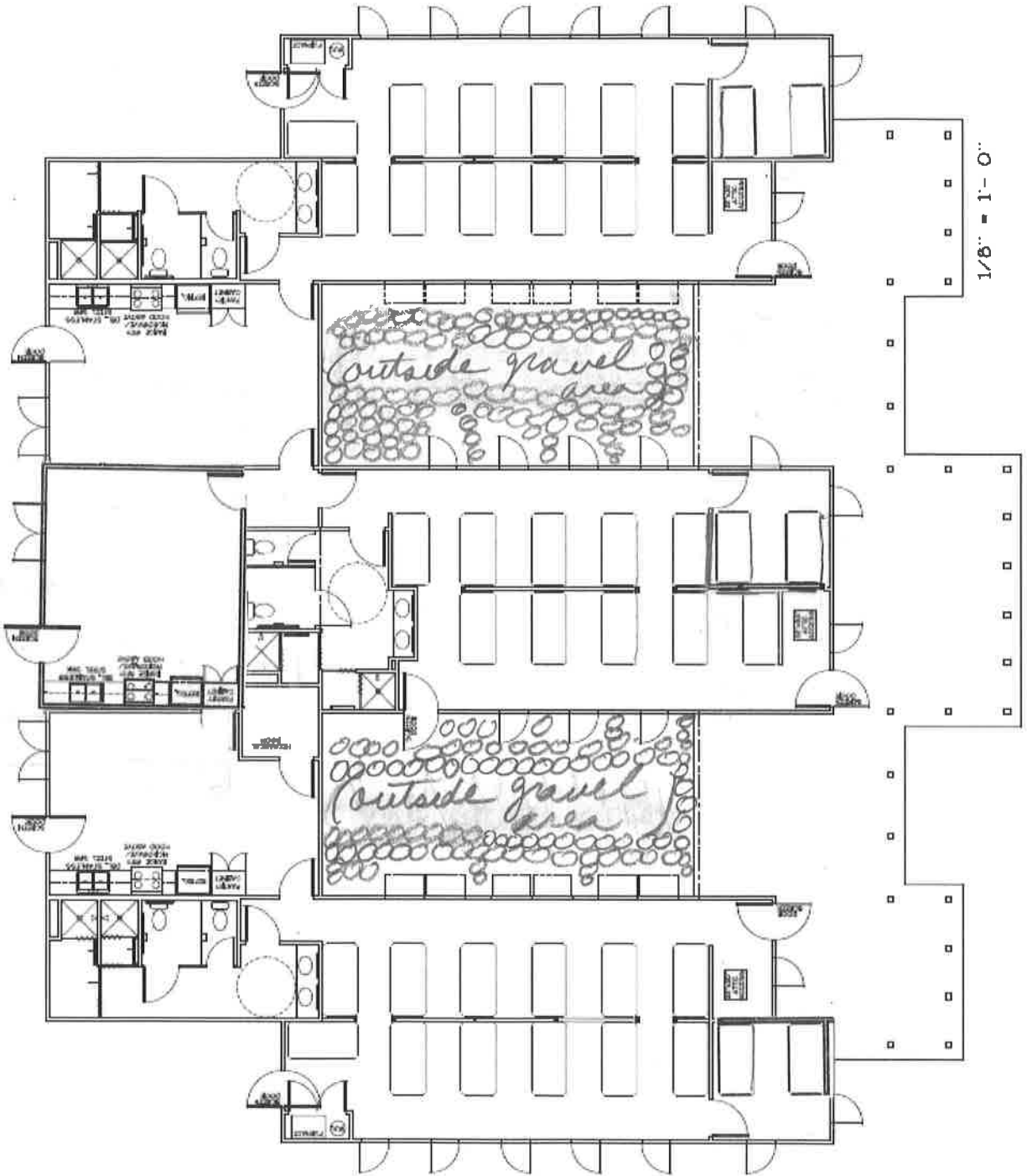

GIRL SCOUTS OF CENTRAL INDIANA PROPERTY CHECK-IN/CHECK-OUT USAGE REPORT

Group Leaders Name (Please Print): _____ Date: _____

Troop # or Organization's Name: _____

Building(s)/Area(s) Used: _____

Upon Arrival, We found the following		<i>Please leave Girl Scout facilities cleaner than you found them.</i>	Upon Departure, We left the following	
Yes	No		Yes	No
		1. Tables, chairs and materials left in correct location.		
		2. Windows closed and locked. Shutters open (Nov. – Apr.)		
		3. All personal items removed.		
		4. Refrigerator/freezer clean and empty.		
		5. Appliances, sinks, & counters clean.		
		6. Equipment cleaned and returned.		
		7. Bathroom swept, faucets turned off, toilets flushed & cleaned.		
		8. All lights turned off. (except emergency lights if applicable)		
		9. Floors swept and cleaned.		
		10. Trash taken to dumpster or exterior trash can cages. (don't forget bathroom and sanitary bins)		
		11. Latrines cleaned (if appropriate).		
		12. Grounds free of litter.		

Signature of Group Leader: _____ Date: _____

We welcome your comments or suggestions: _____

Report any repairs here; _____

GROUP USAGE REPORT

of Girls: _____ # of Boys: _____ # of Adults: F) _____ M) _____

Total in your group: _____

Thank you for using Girl Scouts of Central Indiana properties. Please come again!

Directions to Camp Gallahue

(From Bloomington, IN - College Mall)

Camp Gallahue
6758 Bear Creek Road
Morgantown, IN 46160
(812) 597-4692

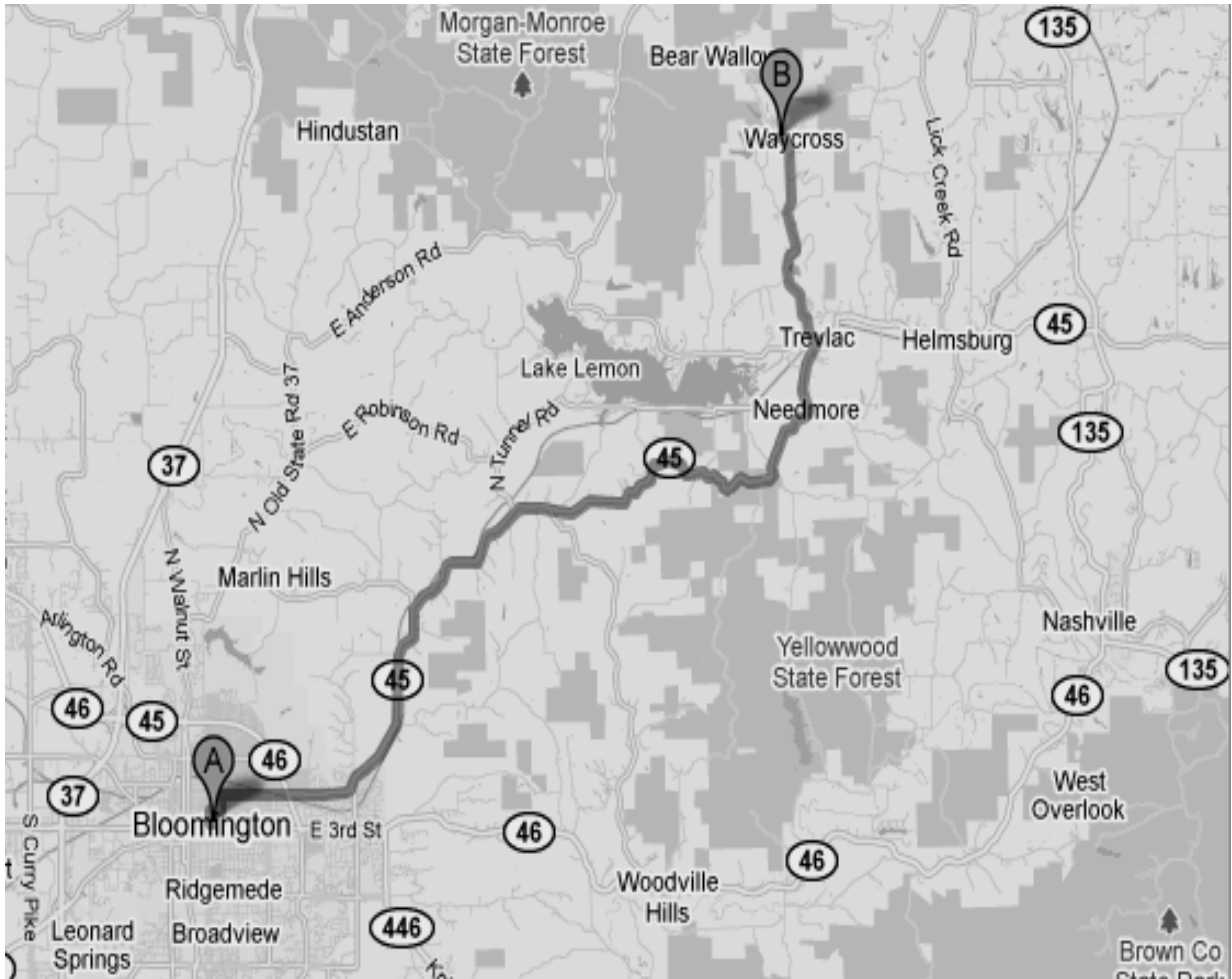

From Bloomington, IN: (From College Mall)

Drive East on 3rd Street .7 miles to S. Smith Road. Turn left onto S. Smith Road and continue .6 miles to 10th Street (also called State Road 45). Turn right onto 10th St./SR 45 and continue East for 13.1 miles (You will pass Unionville Elementary School about 6.4 miles along SR 45. In 6.7 more miles--at 13.1 miles total, you will see "Self's Bait and Supply" shop on your right.)

Take your next possible left onto Bear Creek Road. .4 miles to stop sign. Turn left at the stop sign onto North Bear Creek Road. (It has no street sign, but will be a 4 way intersection with Richards--which is what Bear Creek becomes if you mistakenly go straight ahead onto the gravel). Continue 1.7 miles on North Bear Creek Road to Dudley Gallahue Valley Camp on your left. Turn left into Gallahue Valley Camp, and drive up the gravel drive .7 miles.

DUDLEY GALLAHUE VALLEY CAMPS HILLS OF GALLAHUE

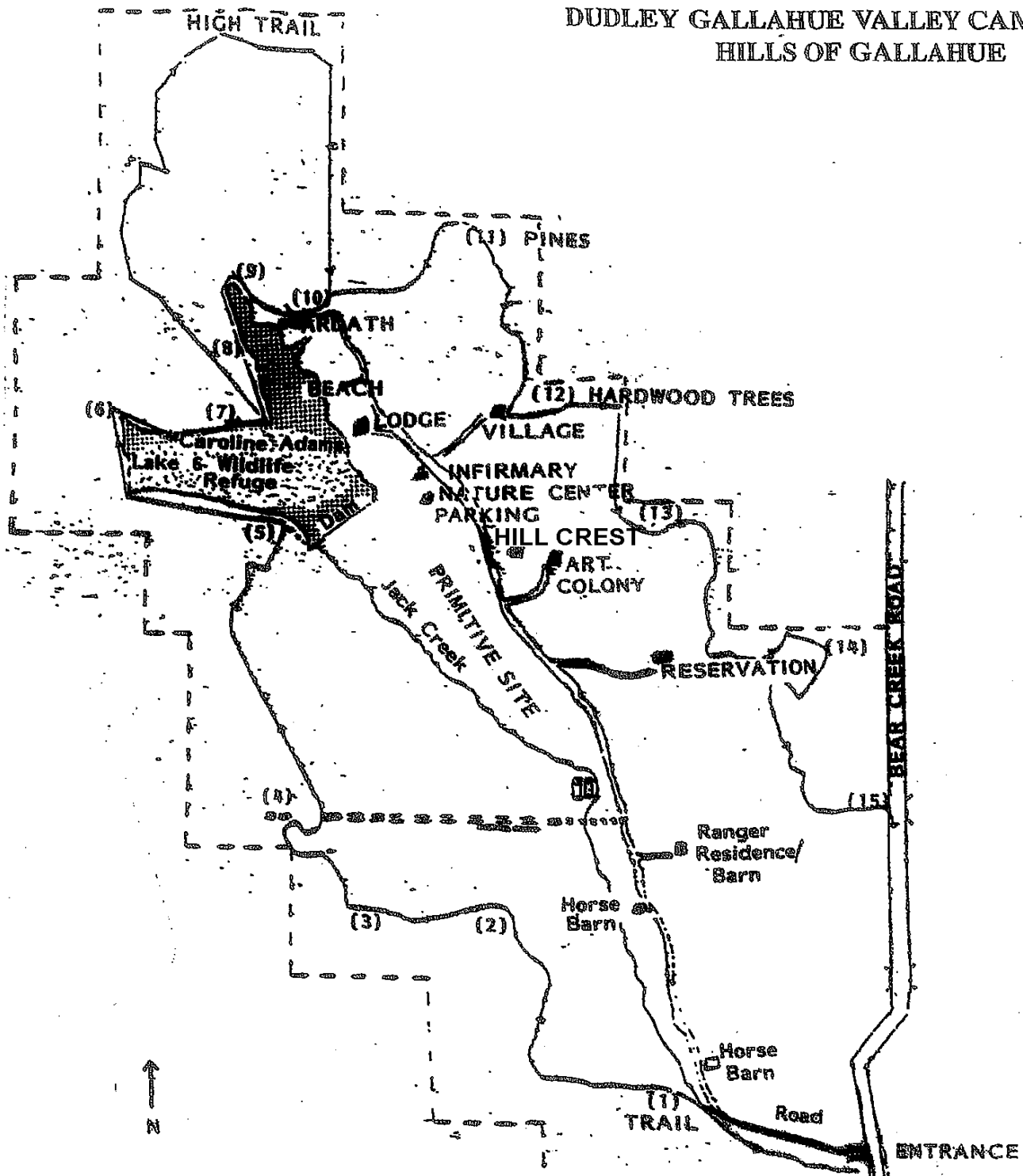





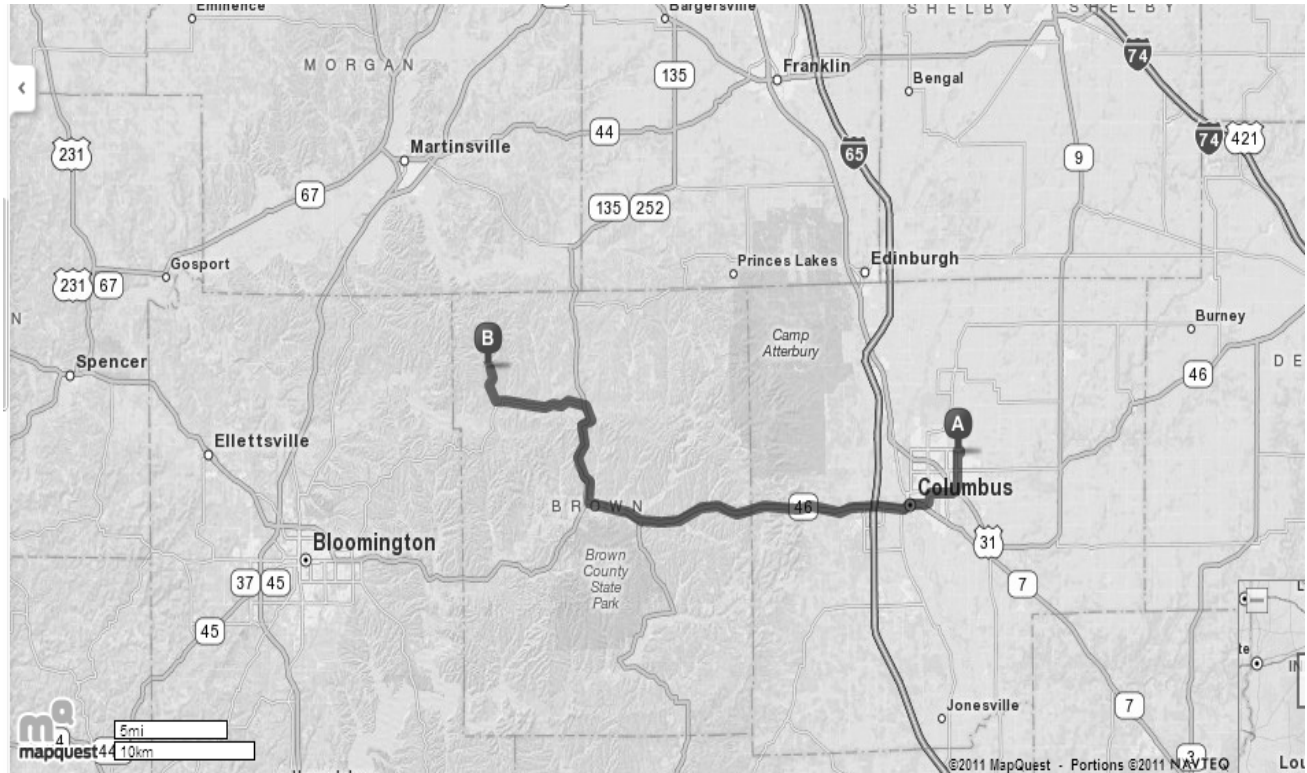







PHONE NUMBER AT CAMP GALLAHUE IS (812) 597-4692

DIRECTIONS to Camp Gallahue (From Columbus, IN)



- 
1. Start out going NORTH on DUFFER DR 0.09 mi
toward CHIPPER RD.
- 
2. Take the 1st LEFT onto CHIPPER RD. 0.1 mi
If you reach ROCKY FORD RD you've gone about 0.1 miles too far
- 
3. Turn LEFT onto TAYLOR RD. 1.8 mi
- 
4. TAYLOR RD becomes 10TH ST. 1.5 mi
- 
5. Turn LEFT onto CENTRAL AVE. 0.6 mi
CENTRAL AVE is just past PENNSYLVANIA ST
- 
6. Turn SLIGHT RIGHT. 0.1 mi
0.4 miles past 7TH ST
- 
7. Turn SLIGHT RIGHT onto 3RD ST/IN-46 W/IN-7 W. Continue to follow IN-46 W. 1.0 mi
- 
8. Keep LEFT at the fork to go on IN-11 S/IN-46 W. 0.06 mi

(continued)

		9. Turn RIGHT onto IN-46 W / JONATHAN MOORE PIKE. Continue to follow IN-46 W. <i>If you are on JONESVILLE RD and reach GARDEN ST you've gone about 0.8 miles too far</i>	Go 17.5 Mi
		10. Turn RIGHT onto S VAN BUREN ST / IN-135. Continue to follow IN-135.	Go 5.3 Mi
		11. Turn LEFT onto IN-45. <i>IN-45 is just past COVERED BRIDGE RD</i>	Go 1.9 Mi
		12. Turn LEFT to stay on IN-45.	Go 2.7 Mi
		13. Turn RIGHT onto BRANSTETTER RD. <i>BRANSTETTER RD is 0.5 miles past CARMEL RIDGE RD</i>	Go 0.6 Mi
		14. BRANSTETTER RD becomes BEAR CREEK RD.	Go 1.7 Mi
		15. 6758 N BEAR CREEK RD. <i>If you reach JACK CREEK RD you've gone a little too far</i>	
		6758 N Bear Creek Rd Morgantown, IN 46160-9057 Add a Note	35.1 mi

Total Travel Estimate: **35.09 miles - about 56 minutes**

DIRECTIONS TO GALLAHUE VALLEY CAMPS

Follow state road 135 south from Indianapolis to Beanblossom. At Beanblossom turn west (right) on state road 45. Continue on 45 to 3 way stop at railroad tracks. Turn left to continue on 45 through Helmsburg. Two miles after Helmsburg General Store, turn right at Gallahue sign onto Branstetter Road; at stop sign continue straight on Bear Creek Road and continue until reaching sign on your left indicating Gallahue entrance. **OR** Continue on 45 past fire station and cross railroad tracks to Trevlac. Turn right over railroad tracks and continue to the right on road to stop sign. Turn left onto Bear Creek Road and continue until reaching sign on your left indicating Gallahue Valley Girl Scout Camp entrance. *(Directions Note: For persons who aren't familiar with State Road 135, it is the same as south Meridian Street on Indianapolis' south side). However, there is not an exit off I-465 to south Meridian Street. You will need take the U.S. 31 South exit off I-465 and go south to the first stoplight (Thompson Road). Turn right (west) on Thompson Road and continue to the next stoplight (intersection of Thompson Road and south Meridian Street), turn left (south) at the light and follow directions above).*

Jackson Township in Brown County

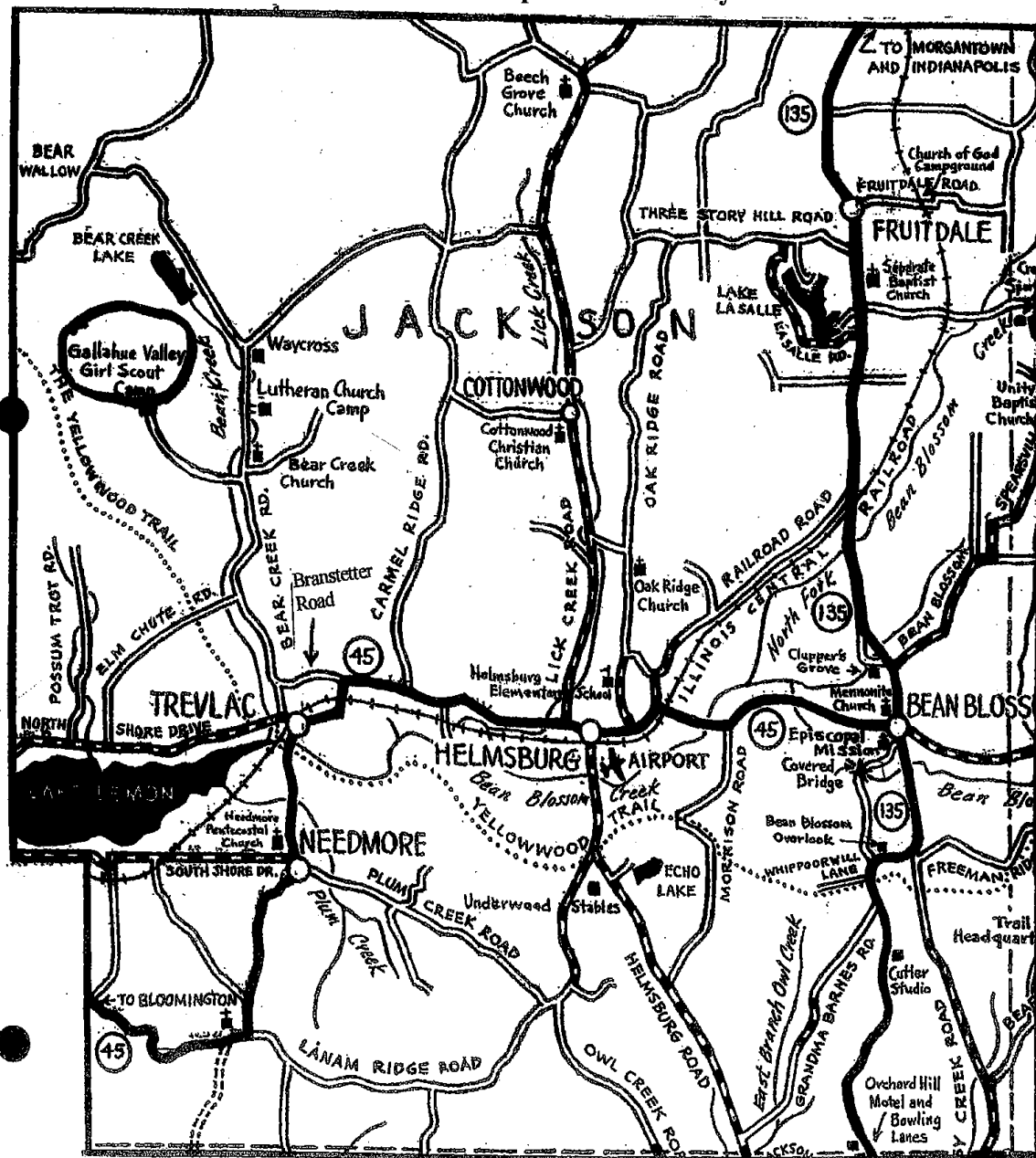

Map of Gallahue

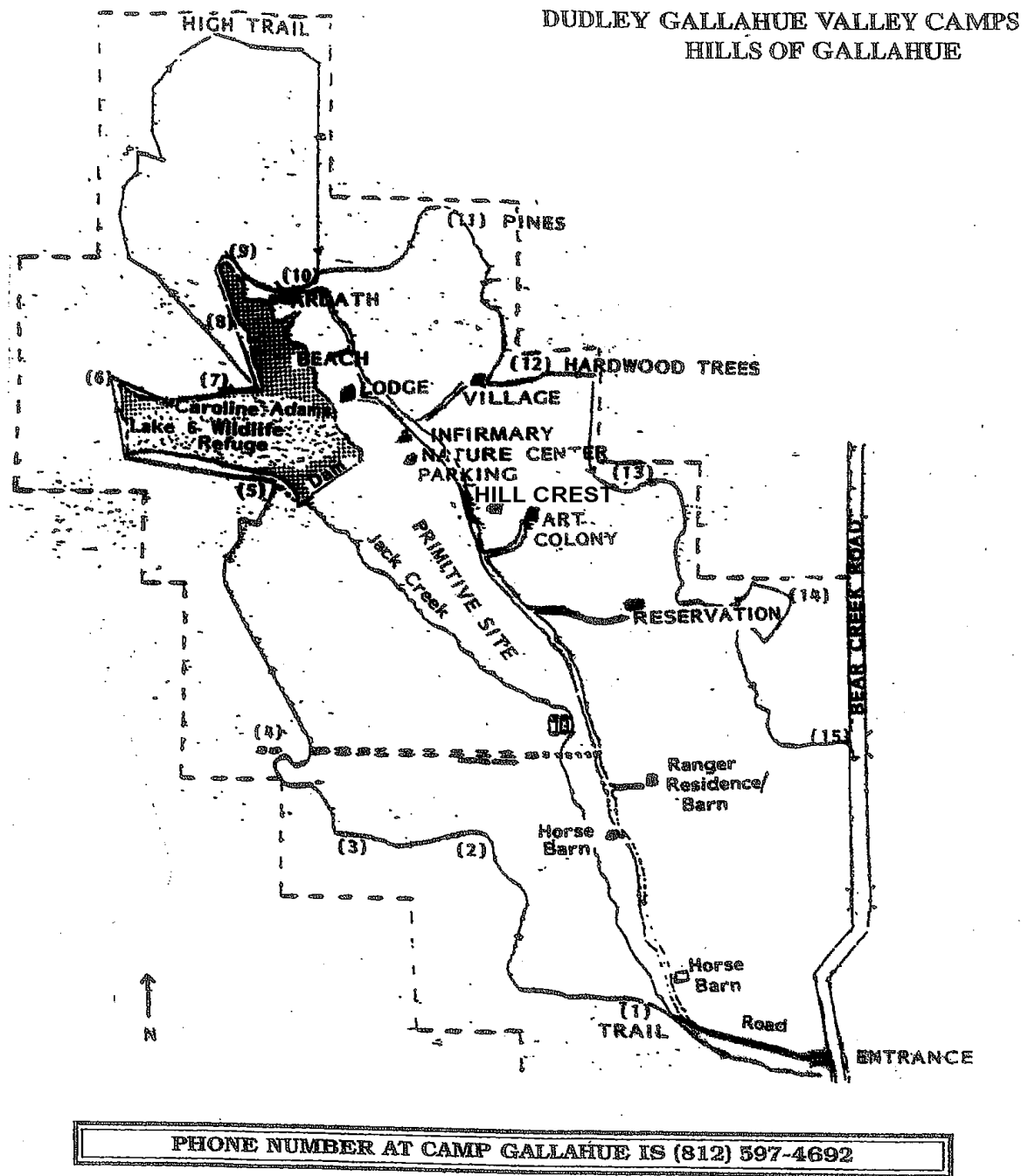

Map-G2
10/98
PW/brc

Dudley Gallahue Valley Camp

6758 Bear Creek Road
Morgantown, IN 46160

Directions to Camp Gallahue

(From Martinsville, IN on IN-37)

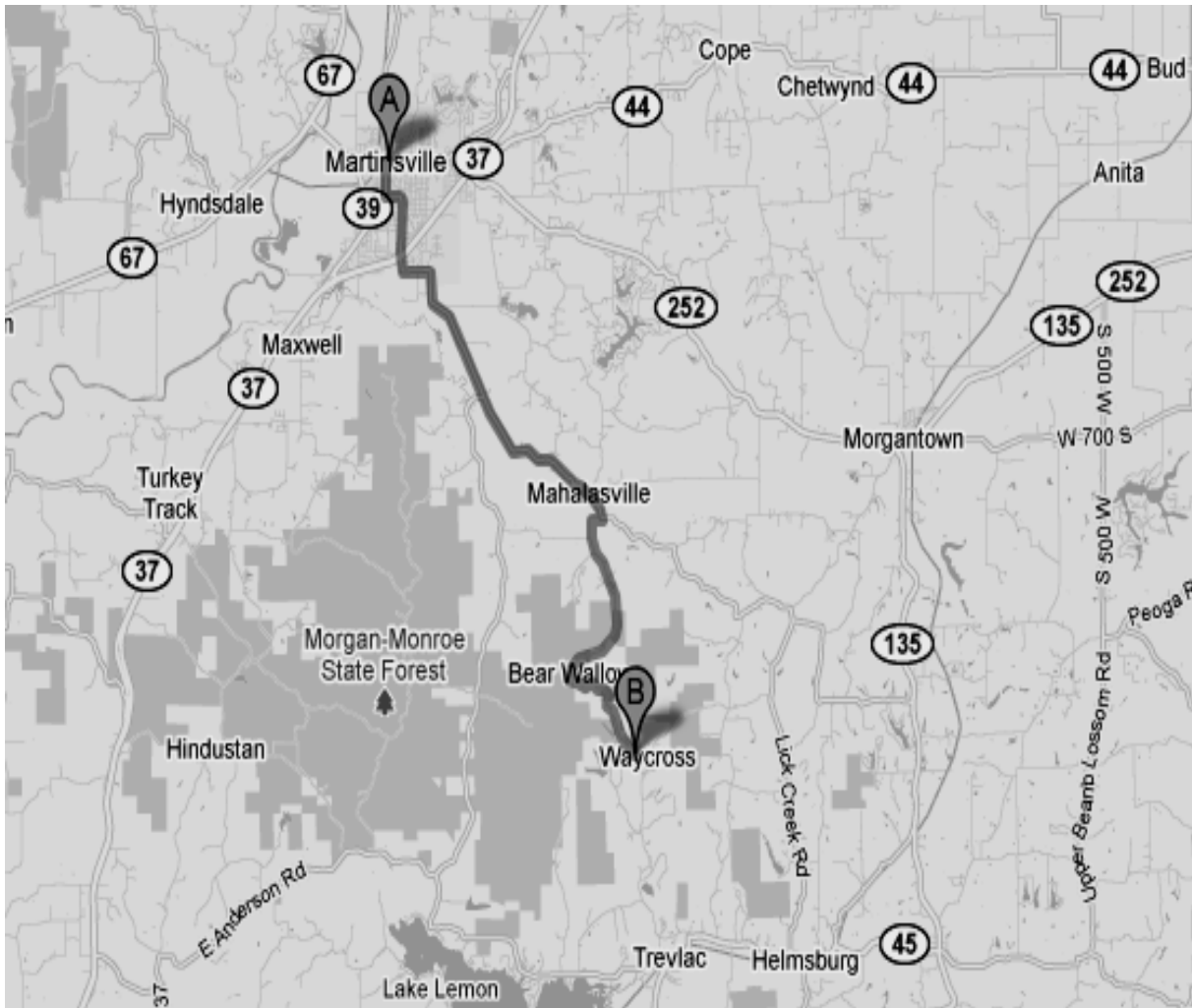

	At the Shell Gas station on IN-37 in Martinsville head S Mahalasville Rd	About 1 min	go 0.5 mi
➡	Turn right to stay on E Mahalasville Rd	About 9 mins	go 5.0 mi
➡	Turn right at Bear Wallow Rd/Co Rd 450 S Continue to follow Bear Wallow Rd	About 4 mins	go 1.4 mi
➡	Turn right at Bear Creek Rd (Waycross camp will be on your left side)	About 9 mins	go 3.5 mi
➡	Camp Gallahue will be on your right (when you get on black top it will be the next entrance on the right)	6758 Bear Creek Rd Morgantown IN 46160	

DUDLEY GALLAHUE VALLEY CAMPS HILLS OF GALLAHUE

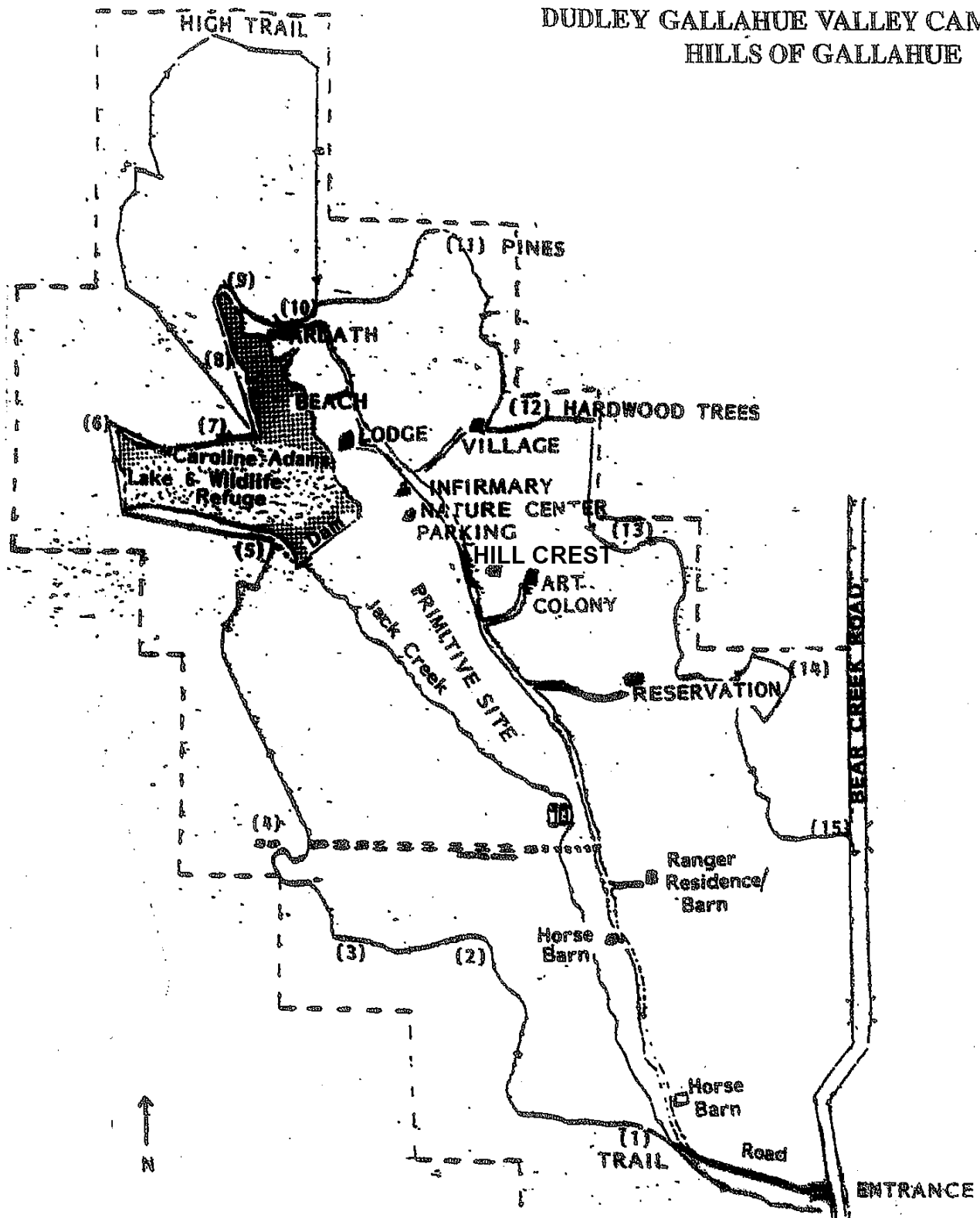

PHONE NUMBER AT CAMP GALLAHUE IS (812) 597-4692